

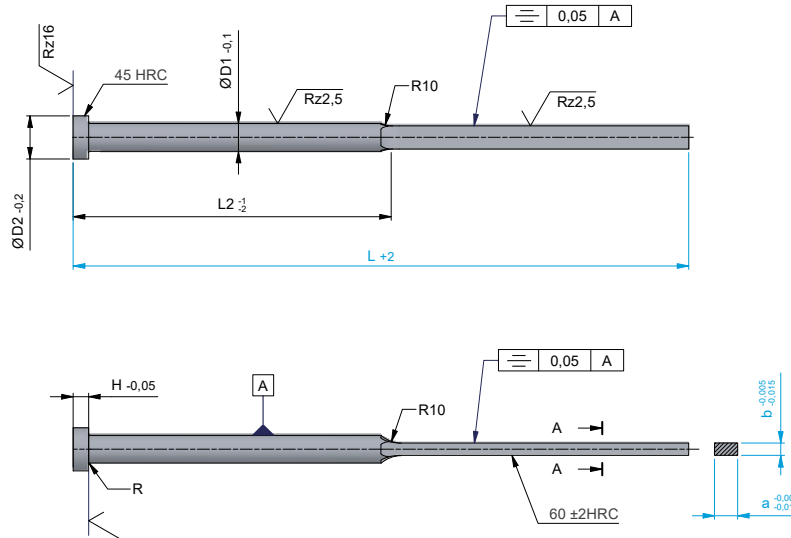

**Z83**  
Flat ejector pin



Mat.: 1.2067  
Norm:  
DIN ISO 6893,  
Form FAH  
950 HV / nitriert

a	b	L	L2	D1	D2	H	R	Order No.	a	b	L	L2	D1	D2	H	R	Order No.
1.8	0.6	63	30	2	4	2	0.2	Z83-1.8-0.6-63	2.8	0.5	160	80	3	6	3	0.3	Z83-2.8-0.5-160
1.8	0.6	80	40	2	4	2	0.2	Z83-1.8-0.6-80	2.8	0.6	80	40	3	6	3	0.3	Z83-2.8-0.6-80
1.8	0.6	100	50	2	4	2	0.2	Z83-1.8-0.6-100	2.8	0.6	100	50	3	6	3	0.3	Z83-2.8-0.6-100
1.8	0.6	125	60	2	4	2	0.2	Z83-1.8-0.6-125	2.8	0.6	125	60	3	6	3	0.3	Z83-2.8-0.6-125
1.8	0.6	160	80	2	4	2	0.2	Z83-1.8-0.6-160	2.8	0.6	160	80	3	6	3	0.3	Z83-2.8-0.6-160
1.8	0.6	200	100	2	4	2	0.2	Z83-1.8-0.6-200	2.8	0.6	200	100	3	6	3	0.3	Z83-2.8-0.6-200
1.8	0.7	63	30	2	4	2	0.2	Z83-1.8-0.7-63	2.8	0.6	250	125	3	6	3	0.3	Z83-2.8-0.6-250
1.8	0.7	80	40	2	4	2	0.2	Z83-1.8-0.7-80	2.8	0.7	80	40	3	6	3	0.3	Z83-2.8-0.7-80
1.8	0.7	100	50	2	4	2	0.2	Z83-1.8-0.7-100	2.8	0.7	100	50	3	6	3	0.3	Z83-2.8-0.7-100
1.8	0.7	125	60	2	4	2	0.2	Z83-1.8-0.7-125	2.8	0.7	125	60	3	6	3	0.3	Z83-2.8-0.7-125
1.8	0.7	160	80	2	4	2	0.2	Z83-1.8-0.7-160	2.8	0.7	160	80	3	6	3	0.3	Z83-2.8-0.7-160
1.8	0.8	63	30	2	4	2	0.2	Z83-1.8-0.8-63	2.8	0.7	200	100	3	6	3	0.3	Z83-2.8-0.7-200
1.8	0.8	80	40	2	4	2	0.2	Z83-1.8-0.8-80	2.8	0.7	250	125	3	6	3	0.3	Z83-2.8-0.7-250
1.8	0.8	100	50	2	4	2	0.2	Z83-1.8-0.8-100	2.8	0.8	80	40	3	6	3	0.3	Z83-2.8-0.8-80
1.8	0.8	125	60	2	4	2	0.2	Z83-1.8-0.8-125	2.8	0.8	100	50	3	6	3	0.3	Z83-2.8-0.8-100
1.8	0.8	160	80	2	4	2	0.2	Z83-1.8-0.8-160	2.8	0.8	125	60	3	6	3	0.3	Z83-2.8-0.8-125
1.8	0.8	200	100	2	4	2	0.2	Z83-1.8-0.8-200	2.8	0.8	160	80	3	6	3	0.3	Z83-2.8-0.8-160
1.8	0.8	250	125	2	4	2	0.2	Z83-1.8-0.8-250	2.8	0.8	200	100	3	6	3	0.3	Z83-2.8-0.8-200
1.8	0.8	315	160	2	4	2	0.2	Z83-1.8-0.8-315	2.8	0.8	250	125	3	6	3	0.3	Z83-2.8-0.8-250
2	2	100	50	3	6	3	0.3	Z83-2-2-100	2.8	0.8	315	160	3	6	3	0.3	Z83-2.8-0.8-315
2	2	125	60	3	6	3	0.3	Z83-2-2-125	2.8	0.8	400	200	3	6	3	0.3	Z83-2.8-0.8-400
2	2	160	80	3	6	3	0.3	Z83-2-2-160	2.8	0.9	100	50	3	6	3	0.3	Z83-2.8-0.9-100
2	2	200	100	3	6	3	0.3	Z83-2-2-200	2.8	0.9	125	60	3	6	3	0.3	Z83-2.8-0.9-125
2	2	250	125	3	6	3	0.3	Z83-2-2-250	2.8	0.9	160	80	3	6	3	0.3	Z83-2.8-0.9-160
2	2	315	160	3	6	3	0.3	Z83-2-2-315	2.8	0.9	200	100	3	6	3	0.3	Z83-2.8-0.9-200
2.3	0.8	100	50	2.3	5	2	0.3	Z83-2.3-0.8-100	2.8	0.9	250	125	3	6	3	0.3	Z83-2.8-0.9-250
2.3	0.8	125	60	2.3	5	2	0.3	Z83-2.3-0.8-125	2.8	0.9	315	160	3	6	3	0.3	Z83-2.8-0.9-315
2.3	0.8	160	80	2.3	5	2	0.3	Z83-2.3-0.8-160	2.8	1	63	30	3	6	3	0.3	Z83-2.8-1-63
2.3	0.8	200	100	2.3	5	2	0.3	Z83-2.3-0.8-200	2.8	1	80	40	3	6	3	0.3	Z83-2.8-1-80
2.8	0.5	80	40	3	6	3	0.3	Z83-2.8-0.5-80	2.8	1	100	50	3	6	3	0.3	Z83-2.8-1-100
2.8	0.5	100	50	3	6	3	0.3	Z83-2.8-0.5-100	2.8	1	125	60	3	6	3	0.3	Z83-2.8-1-125
2.8	0.5	125	60	3	6	3	0.3	Z83-2.8-0.5-125	2.8	1	160	80	3	6	3	0.3	Z83-2.8-1-160



## Z83

Flat ejector pin



a	b	L	L2	D1	D2	H	R	Order No.	a	b	L	L2	D1	D2	H	R	Order No.
2.8	1	200	100	3	6	3	0.3	Z83-2.8-1-200	3.8	0.7	250	125	4.2	8	3	0.3	Z83-3.8-0.7-250
2.8	1	250	125	3	6	3	0.3	Z83-2.8-1-250	3.8	0.8	60	30	4.2	8	3	0.3	Z83-3.8-0.8-60
2.8	1	315	160	3	6	3	0.3	Z83-2.8-1-315	3.8	0.8	63	30	4.2	8	3	0.3	Z83-3.8-0.8-63
2.8	1	400	200	3	6	3	0.3	Z83-2.8-1-400	3.8	0.8	80	40	4.2	8	3	0.3	Z83-3.8-0.8-80
3	3	100	50	5	10	3	0.3	Z83-3-3-100	3.8	0.8	100	50	4.2	8	3	0.3	Z83-3.8-0.8-100
3	3	125	60	5	10	3	0.3	Z83-3-3-125	3.8	0.8	125	60	4.2	8	3	0.3	Z83-3.8-0.8-125
3	3	160	80	5	10	3	0.3	Z83-3-3-160	3.8	0.8	160	80	4.2	8	3	0.3	Z83-3.8-0.8-160
3	3	200	100	5	10	3	0.3	Z83-3-3-200	3.8	0.8	200	100	4.2	8	3	0.3	Z83-3.8-0.8-200
3	3	250	125	5	10	3	0.3	Z83-3-3-250	3.8	0.8	250	125	4.2	8	3	0.3	Z83-3.8-0.8-250
3	3	315	160	5	10	3	0.3	Z83-3-3-315	3.8	0.8	315	160	4.2	8	3	0.3	Z83-3.8-0.8-315
3.3	0.8	100	50	4	8	3	0.3	Z83-3.3-0.8-100	3.8	0.8	400	200	4.2	8	3	0.3	Z83-3.8-0.8-400
3.3	0.8	125	60	4	8	3	0.3	Z83-3.3-0.8-125	3.8	0.8	500	250	4.2	8	3	0.3	Z83-3.8-0.8-500
3.3	0.8	160	80	4	8	3	0.3	Z83-3.3-0.8-160	3.8	0.9	100	50	4.2	8	3	0.3	Z83-3.8-0.9-100
3.3	0.8	200	100	4	8	3	0.3	Z83-3.3-0.8-200	3.8	0.9	125	60	4.2	8	3	0.3	Z83-3.8-0.9-125
3.3	0.8	250	125	4	8	3	0.3	Z83-3.3-0.8-250	3.8	0.9	160	80	4.2	8	3	0.3	Z83-3.8-0.9-160
3.5	1	60	30	4	8	3	0.3	Z83-3.5-1-60	3.8	0.9	200	100	4.2	8	3	0.3	Z83-3.8-0.9-200
3.5	1	63	30	4	8	3	0.3	Z83-3.5-1-63	3.8	0.9	250	125	4.2	8	3	0.3	Z83-3.8-0.9-250
3.5	1	80	40	4	8	3	0.3	Z83-3.5-1-80	3.8	1	60	30	4.2	8	3	0.3	Z83-3.8-1-60
3.5	1	100	50	4	8	3	0.3	Z83-3.5-1-100	3.8	1	63	30	4.2	8	3	0.3	Z83-3.8-1-63
3.5	1	125	60	4	8	3	0.3	Z83-3.5-1-125	3.8	1	80	40	4.2	8	3	0.3	Z83-3.8-1-80
3.5	1	160	80	4	8	3	0.3	Z83-3.5-1-160	3.8	1	100	50	4.2	8	3	0.3	Z83-3.8-1-100
3.5	1	200	100	4	8	3	0.3	Z83-3.5-1-200	3.8	1	125	60	4.2	8	3	0.3	Z83-3.8-1-125
3.5	1	250	125	4	8	3	0.3	Z83-3.5-1-250	3.8	1	160	80	4.2	8	3	0.3	Z83-3.8-1-160
3.5	1	315	160	4	8	3	0.3	Z83-3.5-1-315	3.8	1	200	100	4.2	8	3	0.3	Z83-3.8-1-200
3.5	1	400	200	4	8	3	0.3	Z83-3.5-1-400	3.8	1	250	125	4.2	8	3	0.3	Z83-3.8-1-250
3.5	1.5	100	50	4.2	8	3	0.3	Z83-3.5-1.5-100	3.8	1	315	160	4.2	8	3	0.3	Z83-3.8-1-315
3.5	1.5	125	60	4.2	8	3	0.3	Z83-3.5-1.5-125	3.8	1	400	200	4.2	8	3	0.3	Z83-3.8-1-400
3.5	1.5	160	80	4.2	8	3	0.3	Z83-3.5-1.5-160	3.8	1	500	250	4.2	8	3	0.3	Z83-3.8-1-500
3.5	1.5	200	100	4.2	8	3	0.3	Z83-3.5-1.5-200	3.8	1.2	80	40	4.2	8	3	0.3	Z83-3.8-1.2-80
3.5	1.5	250	125	4.2	8	3	0.3	Z83-3.5-1.5-250	3.8	1.2	100	50	4.2	8	3	0.3	Z83-3.8-1.2-100
3.5	1.5	315	160	4.2	8	3	0.3	Z83-3.5-1.5-315	3.8	1.2	125	60	4.2	8	3	0.3	Z83-3.8-1.2-125
3.5	1.5	400	200	4.2	8	3	0.3	Z83-3.5-1.5-400	3.8	1.2	160	80	4.2	8	3	0.3	Z83-3.8-1.2-160
3.5	2	100	50	4.2	8	3	0.3	Z83-3.5-2-100	3.8	1.2	200	100	4.2	8	3	0.3	Z83-3.8-1.2-200
3.5	2	125	60	4.2	8	3	0.3	Z83-3.5-2-125	3.8	1.2	250	125	4.2	8	3	0.3	Z83-3.8-1.2-250
3.5	2	160	80	4.2	8	3	0.3	Z83-3.5-2-160	3.8	1.2	315	160	4.2	8	3	0.3	Z83-3.8-1.2-315
3.5	2	200	100	4.2	8	3	0.3	Z83-3.5-2-200	3.8	1.2	400	200	4.2	8	3	0.3	Z83-3.8-1.2-400
3.5	2	250	125	4.2	8	3	0.3	Z83-3.5-2-250	3.8	1.2	500	250	4.2	8	3	0.3	Z83-3.8-1.2-500
3.5	2	315	160	4.2	8	3	0.3	Z83-3.5-2-315	4	4	100	50	6	12	5	0.5	Z83-4-4-100
3.5	2	400	200	4.2	8	3	0.3	Z83-3.5-2-400	4	4	125	60	6	12	5	0.5	Z83-4-4-125
3.8	0.5	80	40	4.2	8	3	0.3	Z83-3.8-0.5-80	4	4	160	80	6	12	5	0.5	Z83-4-4-160
3.8	0.5	100	50	4.2	8	3	0.3	Z83-3.8-0.5-100	4	4	200	100	6	12	5	0.5	Z83-4-4-200
3.8	0.5	125	60	4.2	8	3	0.3	Z83-3.8-0.5-125	4	4	250	125	6	12	5	0.5	Z83-4-4-250
3.8	0.5	160	80	4.2	8	3	0.3	Z83-3.8-0.5-160	4	4	315	160	6	12	5	0.5	Z83-4-4-315
3.8	0.6	80	40	4.2	8	3	0.3	Z83-3.8-0.6-80	4	4	400	200	6	12	5	0.5	Z83-4-4-400
3.8	0.6	100	50	4.2	8	3	0.3	Z83-3.8-0.6-100	4.5	0.6	100	50	5	10	3	0.3	Z83-4.5-0.6-100
3.8	0.6	125	60	4.2	8	3	0.3	Z83-3.8-0.6-125	4.5	0.6	125	60	5	10	3	0.3	Z83-4.5-0.6-125
3.8	0.6	160	80	4.2	8	3	0.3	Z83-3.8-0.6-160	4.5	0.6	160	80	5	10	3	0.3	Z83-4.5-0.6-160
3.8	0.6	200	100	4.2	8	3	0.3	Z83-3.8-0.6-200	4.5	0.6	200	100	5	10	3	0.3	Z83-4.5-0.6-200
3.8	0.6	250	125	4.2	8	3	0.3	Z83-3.8-0.6-250	4.5	0.7	100	50	5	10	3	0.3	Z83-4.5-0.7-100
3.8	0.6	315	160	4.2	8	3	0.3	Z83-3.8-0.6-315	4.5	0.7	125	60	5	10	3	0.3	Z83-4.5-0.7-125
3.8	0.7	80	40	4.2	8	3	0.3	Z83-3.8-0.7-80	4.5	0.7	160	80	5	10	3	0.3	Z83-4.5-0.7-160
3.8	0.7	100	50	4.2	8	3	0.3	Z83-3.8-0.7-100	4.5	0.7	200	100	5	10	3	0.3	Z83-4.5-0.7-200
3.8	0.7	125	60	4.2	8	3	0.3	Z83-3.8-0.7-125	4.5	0.8	80	40	5	10	3	0.3	Z83-4.5-0.8-80
3.8	0.7	160	80	4.2	8	3	0.3	Z83-3.8-0.7-160	4.5	0.8	100	50	5	10	3	0.3	Z83-4.5-0.8-100
3.8	0.7	200	100	4.2	8	3	0.3	Z83-3.8-0.7-200	4.5	0.8	125	60	5	10	3	0.3	Z83-4.5-0.8-125



**Z83**  
*Flat ejector pin*



a	b	L	L2	D1	D2	H	R	Order No.
4.5	0.8	160	80	5	10	3	0.3	Z83-4.5-0.8-160
4.5	0.8	200	100	5	10	3	0.3	Z83-4.5-0.8-200
4.5	0.8	250	125	5	10	3	0.3	Z83-4.5-0.8-250
4.5	0.8	315	160	5	10	3	0.3	Z83-4.5-0.8-315
4.5	0.8	400	200	5	10	3	0.3	Z83-4.5-0.8-400
4.5	1	63	30	5	10	3	0.3	Z83-4.5-1-63
4.5	1	80	40	5	10	3	0.3	Z83-4.5-1-80
4.5	1	100	50	5	10	3	0.3	Z83-4.5-1-100
4.5	1	125	60	5	10	3	0.3	Z83-4.5-1-125
4.5	1	160	80	5	10	3	0.3	Z83-4.5-1-160
4.5	1	200	100	5	10	3	0.3	Z83-4.5-1-200
4.5	1	250	125	5	10	3	0.3	Z83-4.5-1-250
4.5	1	315	160	5	10	3	0.3	Z83-4.5-1-315
4.5	1	400	200	5	10	3	0.3	Z83-4.5-1-400
4.5	1	500	250	5	10	3	0.3	Z83-4.5-1-500
4.5	1.2	80	40	5	10	3	0.3	Z83-4.5-1.2-80
4.5	1.2	100	50	5	10	3	0.3	Z83-4.5-1.2-100
4.5	1.2	125	60	5	10	3	0.3	Z83-4.5-1.2-125
4.5	1.2	160	80	5	10	3	0.3	Z83-4.5-1.2-160
4.5	1.2	200	100	5	10	3	0.3	Z83-4.5-1.2-200
4.5	1.2	250	125	5	10	3	0.3	Z83-4.5-1.2-250
4.5	1.2	315	160	5	10	3	0.3	Z83-4.5-1.2-315
4.5	1.2	400	200	5	10	3	0.3	Z83-4.5-1.2-400
4.5	1.2	500	250	5	10	3	0.3	Z83-4.5-1.2-500
4.5	1.5	80	40	5	10	3	0.3	Z83-4.5-1.5-80
4.5	1.5	100	50	5	10	3	0.3	Z83-4.5-1.5-100
4.5	1.5	125	60	5	10	3	0.3	Z83-4.5-1.5-125
4.5	1.5	160	80	5	10	3	0.3	Z83-4.5-1.5-160
4.5	1.5	200	100	5	10	3	0.3	Z83-4.5-1.5-200
4.5	1.5	250	125	5	10	3	0.3	Z83-4.5-1.5-250
4.5	1.5	315	160	5	10	3	0.3	Z83-4.5-1.5-315
4.5	1.5	400	200	5	10	3	0.3	Z83-4.5-1.5-400
4.5	1.5	500	250	5	10	3	0.3	Z83-4.5-1.5-500
5	3	100	50	6	12	5	0.5	Z83-5-3-100
5	3	125	60	6	12	5	0.5	Z83-5-3-125
5	3	160	80	6	12	5	0.5	Z83-5-3-160
5	3	200	100	6	12	5	0.5	Z83-5-3-200
5	3	250	125	6	12	5	0.5	Z83-5-3-250
5	3	315	160	6	12	5	0.5	Z83-5-3-315
5	3	400	200	6	12	5	0.5	Z83-5-3-400
5.5	0.7	100	50	6	12	5	0.5	Z83-5.5-0.7-100
5.5	0.7	125	60	6	12	5	0.5	Z83-5.5-0.7-125
5.5	0.7	160	80	6	12	5	0.5	Z83-5.5-0.7-160
5.5	0.7	200	100	6	12	5	0.5	Z83-5.5-0.7-200
5.5	0.7	250	125	6	12	5	0.5	Z83-5.5-0.7-250
5.5	0.8	80	40	6	12	5	0.5	Z83-5.5-0.8-80
5.5	0.8	100	50	6	12	5	0.5	Z83-5.5-0.8-100
5.5	0.8	125	60	6	12	5	0.5	Z83-5.5-0.8-125
5.5	0.8	160	80	6	12	5	0.5	Z83-5.5-0.8-160
5.5	0.8	200	100	6	12	5	0.5	Z83-5.5-0.8-200
5.5	0.8	250	125	6	12	5	0.5	Z83-5.5-0.8-250
5.5	0.8	315	160	6	12	5	0.5	Z83-5.5-0.8-315
5.5	0.8	400	200	6	12	5	0.5	Z83-5.5-0.8-400
5.5	0.8	500	250	6	12	5	0.5	Z83-5.5-0.8-500
5.5	1	80	40	6	12	5	0.5	Z83-5.5-1-80

a	b	L	L2	D1	D2	H	R	Order No.
5.5	1	100	50	6	12	5	0.5	Z83-5.5-1-100
5.5	1	125	60	6	12	5	0.5	Z83-5.5-1-125
5.5	1	160	80	6	12	5	0.5	Z83-5.5-1-160
5.5	1	200	100	6	12	5	0.5	Z83-5.5-1-200
5.5	1	250	125	6	12	5	0.5	Z83-5.5-1-250
5.5	1	315	160	6	12	5	0.5	Z83-5.5-1-315
5.5	1	400	200	6	12	5	0.5	Z83-5.5-1-400
5.5	1	500	250	6	12	5	0.5	Z83-5.5-1-500
5.5	1.2	80	40	6	12	5	0.5	Z83-5.5-1.2-80
5.5	1.2	100	50	6	12	5	0.5	Z83-5.5-1.2-100
5.5	1.2	125	60	6	12	5	0.5	Z83-5.5-1.2-125
5.5	1.2	160	80	6	12	5	0.5	Z83-5.5-1.2-160
5.5	1.2	200	100	6	12	5	0.5	Z83-5.5-1.2-200
5.5	1.2	250	125	6	12	5	0.5	Z83-5.5-1.2-250
5.5	1.2	315	160	6	12	5	0.5	Z83-5.5-1.2-315
5.5	1.2	400	200	6	12	5	0.5	Z83-5.5-1.2-400
5.5	1.2	500	250	6	12	5	0.5	Z83-5.5-1.2-500
5.5	1.5	80	40	6	12	5	0.5	Z83-5.5-1.5-80
5.5	1.5	100	50	6	12	5	0.5	Z83-5.5-1.5-100
5.5	1.5	125	60	6	12	5	0.5	Z83-5.5-1.5-125
5.5	1.5	160	80	6	12	5	0.5	Z83-5.5-1.5-160
5.5	1.5	200	100	6	12	5	0.5	Z83-5.5-1.5-200
5.5	1.5	250	125	6	12	5	0.5	Z83-5.5-1.5-250
5.5	1.5	315	160	6	12	5	0.5	Z83-5.5-1.5-315
5.5	1.5	400	200	6	12	5	0.5	Z83-5.5-1.5-400
5.5	1.5	500	250	6	12	5	0.5	Z83-5.5-1.5-500
5.5	2	80	40	6	12	5	0.5	Z83-5.5-2-80
5.5	2	100	50	6	12	5	0.5	Z83-5.5-2-100
5.5	2	125	60	6	12	5	0.5	Z83-5.5-2-125
5.5	2	160	80	6	12	5	0.5	Z83-5.5-2-160
5.5	2	200	100	6	12	5	0.5	Z83-5.5-2-200
5.5	2	250	125	6	12	5	0.5	Z83-5.5-2-250
5.5	2	315	160	6	12	5	0.5	Z83-5.5-2-315
5.5	2	400	200	6	12	5	0.5	Z83-5.5-2-400
5.5	2	500	250	6	12	5	0.5	Z83-5.5-2-500
5.5	4	125	60	7	12	5	0.5	Z83-5.5-4-125
5.5	4	160	80	7	12	5	0.5	Z83-5.5-4-160
5.5	4	200	100	7	12	5	0.5	Z83-5.5-4-200
5.5	4	250	125	7	12	5	0.5	Z83-5.5-4-250
5.5	4	315	160	7	12	5	0.5	Z83-5.5-4-315
5.5	5.5	125	60	8	14	5	0.5	Z83-5.5-5.5-125
5.5	5.5	160	80	8	14	5	0.5	Z83-5.5-5.5-160
5.5	5.5	200	100	8	14	5	0.5	Z83-5.5-5.5-200
5.5	5.5	250	125	8	14	5	0.5	Z83-5.5-5.5-250
5.5	5.5	315	160	8	14	5	0.5	Z83-5.5-5.5-315
6.5	3.5	125	60	8	14	5	0.5	Z83-6.5-3.5-125
6.5	3.5	160	80	8	14	5	0.5	Z83-6.5-3.5-160
6.5	3.5	200	100	8	14	5	0.5	Z83-6.5-3.5-200
6.5	3.5	250	125	8	14	5	0.5	Z83-6.5-3.5-250
6.5	3.5	315	160	8	14	5	0.5	Z83-6.5-3.5-315
6.5	3.5	400	200	8	14	5	0.5	Z83-6.5-3.5-400
7.5	0.8	125	60	8	14	5	0.5	Z83-7.5-0.8-125
7.5	0.8	160	80	8	14	5	0.5	Z83-7.5-0.8-160
7.5	0.8	200	100	8	14	5	0.5	Z83-7.5-0.8-200
7.5	0.8	250	125	8	14	5	0.5	Z83-7.5-0.8-250



## Z83

Flat ejector pin



a	b	L	L2	D1	D2	H	R	Order No.	a	b	L	L2	D1	D2	H	R	Order No.
7.5	0.8	315	160	8	14	5	0.5	Z83-7.5-0.8-315	9.5	3	200	100	10	16	5	0.5	Z83-9.5-3-200
7.5	1	100	50	8	14	5	0.5	Z83-7.5-1-100	9.5	3	250	125	10	16	5	0.5	Z83-9.5-3-250
7.5	1	125	60	8	14	5	0.5	Z83-7.5-1-125	9.5	3	315	160	10	16	5	0.5	Z83-9.5-3-315
7.5	1	160	80	8	14	5	0.5	Z83-7.5-1-160	9.5	3	400	200	10	16	5	0.5	Z83-9.5-3-400
7.5	1	200	100	8	14	5	0.5	Z83-7.5-1-200	9.5	8	125	60	12.5	18	7	0.8	Z83-9.5-8-125
7.5	1	250	125	8	14	5	0.5	Z83-7.5-1-250	9.5	8	160	80	12.5	18	7	0.8	Z83-9.5-8-160
7.5	1.2	315	160	8	14	5	0.5	Z83-7.5-1.2-315	9.5	8	200	100	12.5	18	7	0.8	Z83-9.5-8-200
7.5	1.5	250	125	8	14	5	0.5	Z83-7.5-1.5-250	9.5	8	250	125	12.5	18	7	0.8	Z83-9.5-8-250
7.5	2	250	125	8	14	5	0.5	Z83-7.5-2-250	9.5	8	315	160	12.5	18	7	0.8	Z83-9.5-8-315
7.5	2	315	160	8	14	5	0.5	Z83-7.5-2-315	9.5	9.5	160	80	14	22	7	0.8	Z83-9.5-9.5-160
7.5	2	400	200	8	14	5	0.5	Z83-7.5-2-400	9.5	9.5	200	100	14	22	7	0.8	Z83-9.5-9.5-200
7.5	2	500	250	8	14	5	0.5	Z83-7.5-2-500	9.5	9.5	250	125	14	22	7	0.8	Z83-9.5-9.5-250
7.5	4	125	60	9	14	5	0.5	Z83-7.5-4-125	9.5	9.5	315	160	14	22	7	0.8	Z83-9.5-9.5-315
7.5	4	160	80	9	14	5	0.5	Z83-7.5-4-160	10.5	4	125	60	12	18	7	0.8	Z83-10.5-4-125
7.5	4	200	100	9	14	5	0.5	Z83-7.5-4-200	10.5	4	160	80	12	18	7	0.8	Z83-10.5-4-160
7.5	4	250	125	9	14	5	0.5	Z83-7.5-4-250	10.5	4	200	100	12	18	7	0.8	Z83-10.5-4-200
7.5	4	315	160	9	14	5	0.5	Z83-7.5-4-315	10.5	4	250	125	12	18	7	0.8	Z83-10.5-4-250
8	8	125	60	12	18	7	0.8	Z83-8-8-125	10.5	4	315	160	12	18	7	0.8	Z83-10.5-4-315
8	8	160	80	12	18	7	0.8	Z83-8-8-160	10.5	5.5	160	80	12	18	7	0.8	Z83-10.5-5.5-160
8	8	200	100	12	18	7	0.8	Z83-8-8-200	10.5	5.5	200	100	12	18	7	0.8	Z83-10.5-5.5-200
8	8	250	125	12	18	7	0.8	Z83-8-8-250	10.5	5.5	250	125	12	18	7	0.8	Z83-10.5-5.5-250
8	8	315	160	12	18	7	0.8	Z83-8-8-315	10.5	5.5	315	160	12	18	7	0.8	Z83-10.5-5.5-315
8.5	5	125	60	10	16	5	0.5	Z83-8.5-5-125	11.5	2	160	80	12	18	7	0.8	Z83-11.5-2-160
8.5	5	160	80	10	16	5	0.5	Z83-8.5-5-160	11.5	2	200	100	12	18	7	0.8	Z83-11.5-2-200
8.5	5	200	100	10	16	5	0.5	Z83-8.5-5-200	11.5	2	250	125	12	18	7	0.8	Z83-11.5-2-250
8.5	5	250	125	10	16	5	0.5	Z83-8.5-5-250	11.5	2	315	160	12	18	7	0.8	Z83-11.5-2-315
8.5	5	315	160	10	16	5	0.5	Z83-8.5-5-315	11.5	2	400	200	12	18	7	0.8	Z83-11.5-2-400
8.5	6	125	60	10.5	16	5	0.5	Z83-8.5-6-125	11.5	2.5	160	80	12	18	7	0.8	Z83-11.5-2.5-160
8.5	6	160	80	10.5	16	5	0.5	Z83-8.5-6-160	11.5	2.5	200	100	12	18	7	0.8	Z83-11.5-2.5-200
8.5	6	200	100	10.5	16	5	0.5	Z83-8.5-6-200	11.5	2.5	250	125	12	18	7	0.8	Z83-11.5-2.5-250
8.5	6	250	125	10.5	16	5	0.5	Z83-8.5-6-250	11.5	2.5	315	160	12	18	7	0.8	Z83-11.5-2.5-315
8.5	6	315	160	10.5	16	5	0.5	Z83-8.5-6-315	11.5	2.5	400	200	12	18	7	0.8	Z83-11.5-2.5-400
9.5	1.2	125	60	10	16	5	0.5	Z83-9.5-1.2-125	12	10	125	60	16	22	7	0.8	Z83-12-10-125
9.5	1.2	160	80	10	16	5	0.5	Z83-9.5-1.2-160	12	10	160	80	16	22	7	0.8	Z83-12-10-160
9.5	1.2	200	100	10	16	5	0.5	Z83-9.5-1.2-200	12	10	200	100	16	22	7	0.8	Z83-12-10-200
9.5	1.2	250	125	10	16	5	0.5	Z83-9.5-1.2-250	12	10	250	125	16	22	7	0.8	Z83-12-10-250
9.5	1.2	315	160	10	16	5	0.5	Z83-9.5-1.2-315	12	10	315	160	16	22	7	0.8	Z83-12-10-315
9.5	1.2	400	200	10	16	5	0.5	Z83-9.5-1.2-400	15.5	2	200	100	16	22	7	0.8	Z83-15.5-2-200
9.5	1.2	500	250	10	16	5	0.5	Z83-9.5-1.2-500	15.5	2	250	125	16	22	7	0.8	Z83-15.5-2-250
9.5	1.5	125	60	10	16	5	0.5	Z83-9.5-1.5-125	15.5	2	315	160	16	22	7	0.8	Z83-15.5-2-315
9.5	1.5	160	80	10	16	5	0.5	Z83-9.5-1.5-160	15.5	2	400	200	16	22	7	0.8	Z83-15.5-2-400
9.5	1.5	200	100	10	16	5	0.5	Z83-9.5-1.5-200	15.5	2.5	250	125	16	22	7	0.8	Z83-15.5-2.5-250
9.5	1.5	250	125	10	16	5	0.5	Z83-9.5-1.5-250	15.5	2.5	315	160	16	22	7	0.8	Z83-15.5-2.5-315
9.5	1.5	315	160	10	16	5	0.5	Z83-9.5-1.5-315	15.5	2.5	400	200	16	22	7	0.8	Z83-15.5-2.5-400
9.5	1.5	400	200	10	16	5	0.5	Z83-9.5-1.5-400	16	12	200	100	20	26	8	1	Z83-16-12-200
9.5	1.5	500	250	10	16	5	0.5	Z83-9.5-1.5-500	16	12	250	125	20	26	8	1	Z83-16-12-250
9.5	2	125	60	10	16	5	0.5	Z83-9.5-2-125	16	12	315	160	20	26	8	1	Z83-16-12-315
9.5	2	160	80	10	16	5	0.5	Z83-9.5-2-160	16	12	400	200	20	26	8	1	Z83-16-12-400
9.5	2	200	100	10	16	5	0.5	Z83-9.5-2-200	18	8	200	100	20	26	8	1	Z83-18-8-200
9.5	2	250	125	10	16	5	0.5	Z83-9.5-2-250	18	8	250	125	20	26	8	1	Z83-18-8-250
9.5	2	315	160	10	16	5	0.5	Z83-9.5-2-315	18	8	315	160	20	26	8	1	Z83-18-8-315
9.5	2	400	200	10	16	5	0.5	Z83-9.5-2-400	18	8	400	200	20	26	8	1	Z83-18-8-400
9.5	2	500	250	10	16	5	0.5	Z83-9.5-2-500									
9.5	3	125	60	10	16	5	0.5	Z83-9.5-3-125									
9.5	3	160	80	10	16	5	0.5	Z83-9.5-3-160									