

SN5650-PMO-0230-

Oben hängender Schieber

Aerial cam unit

| | | |
|----------------------------|----------------------------|--------------|
| Arbeitsfläche | <i>Working area</i> | 230 x 137 mm |
| Schieberbreite max. | <i>Cam unit width max.</i> | 230 mm |
| Einbauhöhe | <i>Installation height</i> | 300 mm |
| Schieberkraft | <i>Cam force</i> | > 490 kN |

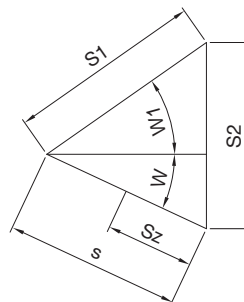
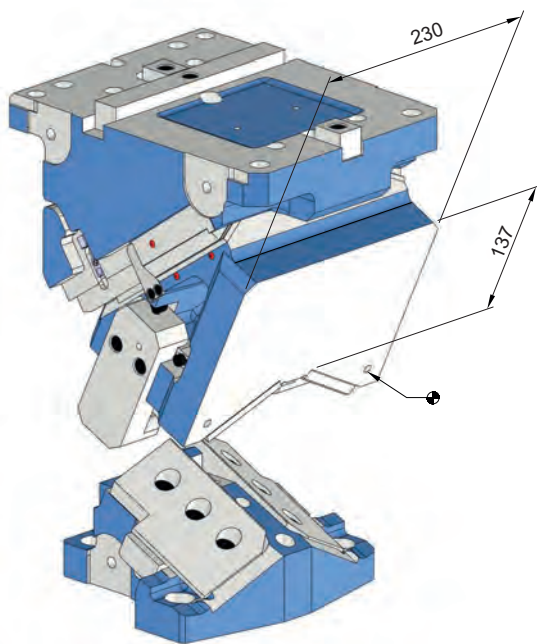
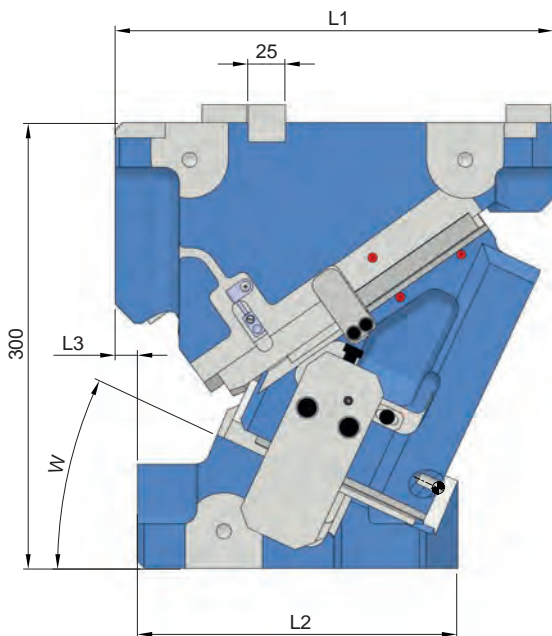

Gusstoleranzgrad CT
nach DIN ISO 8062

(blau = Rohgussfläche)

Casting tolerance grade CT
according to DIN ISO 8062

(blue = raw casting area)

**Positionskontrolle:
Control of position:**



Pos. 1

Schieber zusammengefahren
Cam is moved together



Pos. 2

Schieber ausgefahren
Cam is extended

Sz = Eingriffslänge Aktivrückzug
Sz = Engagement length of activ return

SN5650-PMO-0230-

Oben hängender Schieber

Aerial cam unit

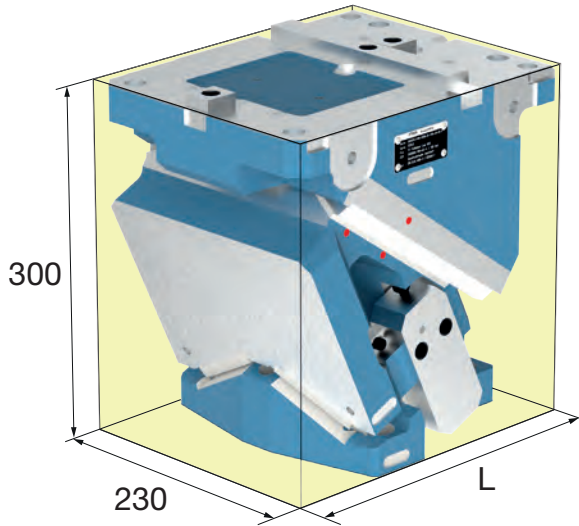

Mat.: EN-GJS-600-3 (GGG 60)

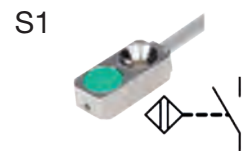

W = Schieberwinkel
Cam Angle

G = Gasdruckfeder
Gas spring

E = Einarbeitung
Machining

SE = Sensor
Sensor

| W | E | G | SE | L | W1 | s | S1 | S2 | Sz | L1 | L2 | L3 | No. |
|-----|----|----|----|-------|----|------|----|------|----|-----|-----|----|---------------------------------|
| 0° | E0 | G0 | S0 | 275 | 47 | 35.5 | 52 | 38 | 16 | 275 | 245 | 30 | SN5650-PMO-0230-00-E0-G0-S0-V04 |
| 0° | E0 | G0 | S1 | 275 | 47 | 35.5 | 52 | 38 | 16 | 275 | 245 | 30 | SN5650-PMO-0230-00-E0-G0-S1-V04 |
| 0° | E0 | G1 | S0 | 275 | 47 | 35.5 | 52 | 38 | 16 | 275 | 245 | 30 | SN5650-PMO-0230-00-E0-G1-S0-V04 |
| 0° | E0 | G1 | S1 | 275 | 47 | 35.5 | 52 | 38 | 16 | 275 | 245 | 30 | SN5650-PMO-0230-00-E0-G1-S1-V04 |
| 0° | E1 | G0 | S0 | 275 | 47 | 35.5 | 52 | 38 | 16 | 275 | 245 | 30 | SN5650-PMO-0230-00-E1-G0-S0-V04 |
| 0° | E1 | G0 | S1 | 275 | 47 | 35.5 | 52 | 38 | 16 | 275 | 245 | 30 | SN5650-PMO-0230-00-E1-G0-S1-V04 |
| 0° | E1 | G1 | S0 | 275 | 47 | 35.5 | 52 | 38 | 16 | 275 | 245 | 30 | SN5650-PMO-0230-00-E1-G1-S0-V04 |
| 0° | E1 | G1 | S1 | 275 | 47 | 35.5 | 52 | 38 | 16 | 275 | 245 | 30 | SN5650-PMO-0230-00-E1-G1-S1-V04 |
| 5° | E0 | G0 | S0 | 276.5 | 45 | 36.9 | 52 | 40 | 21 | 275 | 245 | 30 | SN5650-PMO-0230-05-E0-G0-S0-V04 |
| 5° | E0 | G0 | S1 | 276.5 | 45 | 36.9 | 52 | 40 | 21 | 275 | 245 | 30 | SN5650-PMO-0230-05-E0-G0-S1-V04 |
| 5° | E0 | G1 | S0 | 276.5 | 45 | 36.9 | 52 | 40 | 21 | 275 | 245 | 30 | SN5650-PMO-0230-05-E0-G1-S0-V04 |
| 5° | E0 | G1 | S1 | 276.5 | 45 | 36.9 | 52 | 40 | 21 | 275 | 245 | 30 | SN5650-PMO-0230-05-E0-G1-S1-V04 |
| 5° | E1 | G0 | S0 | 276.5 | 45 | 36.9 | 52 | 40 | 21 | 275 | 245 | 30 | SN5650-PMO-0230-05-E1-G0-S0-V04 |
| 5° | E1 | G0 | S1 | 276.5 | 45 | 36.9 | 52 | 40 | 21 | 275 | 245 | 30 | SN5650-PMO-0230-05-E1-G0-S1-V04 |
| 5° | E1 | G1 | S0 | 276.5 | 45 | 36.9 | 52 | 40 | 21 | 275 | 245 | 30 | SN5650-PMO-0230-05-E1-G1-S0-V04 |
| 5° | E1 | G1 | S1 | 276.5 | 45 | 36.9 | 52 | 40 | 21 | 275 | 245 | 30 | SN5650-PMO-0230-05-E1-G1-S1-V04 |
| 10° | E0 | G0 | S0 | 282 | 42 | 39.2 | 52 | 41.6 | 22 | 280 | 242 | 15 | SN5650-PMO-0230-10-E0-G0-S0-V04 |
| 10° | E0 | G0 | S1 | 282 | 42 | 39.2 | 52 | 41.6 | 22 | 280 | 242 | 15 | SN5650-PMO-0230-10-E0-G0-S1-V04 |
| 10° | E0 | G1 | S0 | 282 | 42 | 39.2 | 52 | 41.6 | 22 | 280 | 242 | 15 | SN5650-PMO-0230-10-E0-G1-S0-V04 |
| 10° | E0 | G1 | S1 | 282 | 42 | 39.2 | 52 | 41.6 | 22 | 280 | 242 | 15 | SN5650-PMO-0230-10-E0-G1-S1-V04 |
| 10° | E1 | G0 | S0 | 282 | 42 | 39.2 | 52 | 41.6 | 22 | 280 | 242 | 15 | SN5650-PMO-0230-10-E1-G0-S0-V04 |
| 10° | E1 | G0 | S1 | 282 | 42 | 39.2 | 52 | 41.6 | 22 | 280 | 242 | 15 | SN5650-PMO-0230-10-E1-G0-S1-V04 |
| 10° | E1 | G1 | S0 | 282 | 42 | 39.2 | 52 | 41.6 | 22 | 280 | 242 | 15 | SN5650-PMO-0230-10-E1-G1-S0-V04 |
| 10° | E1 | G1 | S1 | 282 | 42 | 39.2 | 52 | 41.6 | 22 | 280 | 242 | 15 | SN5650-PMO-0230-10-E1-G1-S1-V04 |
| 15° | E0 | G0 | S0 | 287 | 40 | 41.2 | 52 | 44.1 | 22 | 280 | 242 | 15 | SN5650-PMO-0230-15-E0-G0-S0-V04 |
| 15° | E0 | G0 | S1 | 287 | 40 | 41.2 | 52 | 44.1 | 22 | 280 | 242 | 15 | SN5650-PMO-0230-15-E0-G0-S1-V04 |
| 15° | E0 | G1 | S0 | 287 | 40 | 41.2 | 52 | 44.1 | 22 | 280 | 242 | 15 | SN5650-PMO-0230-15-E0-G1-S0-V04 |
| 15° | E0 | G1 | S1 | 287 | 40 | 41.2 | 52 | 44.1 | 22 | 280 | 242 | 15 | SN5650-PMO-0230-15-E0-G1-S1-V04 |
| 15° | E1 | G0 | S0 | 287 | 40 | 41.2 | 52 | 44.1 | 22 | 280 | 242 | 15 | SN5650-PMO-0230-15-E1-G0-S0-V04 |
| 15° | E1 | G0 | S1 | 287 | 40 | 41.2 | 52 | 44.1 | 22 | 280 | 242 | 15 | SN5650-PMO-0230-15-E1-G0-S1-V04 |
| 15° | E1 | G1 | S0 | 287 | 40 | 41.2 | 52 | 44.1 | 22 | 280 | 242 | 15 | SN5650-PMO-0230-15-E1-G1-S0-V04 |

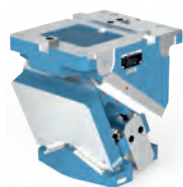

| W | E | G | SE | L | W1 | s | S1 | S2 | Sz | L1 | L2 | L3 | No. |
|-----|----|----|----|-----|----|------|----|------|----|-----|-----|----|---------------------------------|
| 15° | E1 | G1 | S1 | 287 | 40 | 41.2 | 52 | 44.1 | 22 | 280 | 242 | 15 | SN5650-PMO-0230-15-E1-G1-S1-V04 |
| 20° | E0 | G0 | S0 | 295 | 37 | 44.2 | 52 | 46.4 | 27 | 295 | 215 | 15 | SN5650-PMO-0230-20-E0-G0-S0-V04 |
| 20° | E0 | G0 | S1 | 295 | 37 | 44.2 | 52 | 46.4 | 27 | 295 | 215 | 15 | SN5650-PMO-0230-20-E0-G0-S1-V04 |
| 20° | E0 | G1 | S0 | 295 | 37 | 44.2 | 52 | 46.4 | 27 | 295 | 215 | 15 | SN5650-PMO-0230-20-E0-G1-S0-V04 |
| 20° | E0 | G1 | S1 | 295 | 37 | 44.2 | 52 | 46.4 | 27 | 295 | 215 | 15 | SN5650-PMO-0230-20-E0-G1-S1-V04 |
| 20° | E1 | G0 | S0 | 295 | 37 | 44.2 | 52 | 46.4 | 27 | 295 | 215 | 15 | SN5650-PMO-0230-20-E1-G0-S0-V04 |
| 20° | E1 | G0 | S1 | 295 | 37 | 44.2 | 52 | 46.4 | 27 | 295 | 215 | 15 | SN5650-PMO-0230-20-E1-G0-S1-V04 |
| 20° | E1 | G1 | S0 | 295 | 37 | 44.2 | 52 | 46.4 | 27 | 295 | 215 | 15 | SN5650-PMO-0230-20-E1-G1-S0-V04 |
| 20° | E1 | G1 | S1 | 295 | 37 | 44.2 | 52 | 46.4 | 27 | 295 | 215 | 15 | SN5650-PMO-0230-20-E1-G1-S1-V04 |
| 25° | E0 | G0 | S0 | 295 | 35 | 47 | 52 | 49.7 | 32 | 295 | 215 | 15 | SN5650-PMO-0230-25-E0-G0-S0-V04 |
| 25° | E0 | G0 | S1 | 295 | 35 | 47 | 52 | 49.7 | 32 | 295 | 215 | 15 | SN5650-PMO-0230-25-E0-G0-S1-V04 |
| 25° | E0 | G1 | S0 | 295 | 35 | 47 | 52 | 49.7 | 32 | 295 | 215 | 15 | SN5650-PMO-0230-25-E0-G1-S0-V04 |
| 25° | E0 | G1 | S1 | 295 | 35 | 47 | 52 | 49.7 | 32 | 295 | 215 | 15 | SN5650-PMO-0230-25-E0-G1-S1-V04 |
| 25° | E1 | G0 | S0 | 295 | 35 | 47 | 52 | 49.7 | 32 | 295 | 215 | 15 | SN5650-PMO-0230-25-E1-G0-S0-V04 |
| 25° | E1 | G0 | S1 | 295 | 35 | 47 | 52 | 49.7 | 32 | 295 | 215 | 15 | SN5650-PMO-0230-25-E1-G0-S1-V04 |
| 25° | E1 | G1 | S0 | 295 | 35 | 47 | 52 | 49.7 | 32 | 295 | 215 | 15 | SN5650-PMO-0230-25-E1-G1-S0-V04 |
| 25° | E1 | G1 | S1 | 295 | 35 | 47 | 52 | 49.7 | 32 | 295 | 215 | 15 | SN5650-PMO-0230-25-E1-G1-S1-V04 |
| 30° | E0 | G0 | S0 | 305 | 32 | 50.9 | 52 | 53 | 37 | 305 | 195 | 15 | SN5650-PMO-0230-30-E0-G0-S0-V04 |
| 30° | E0 | G0 | S1 | 305 | 32 | 50.9 | 52 | 53 | 37 | 305 | 195 | 15 | SN5650-PMO-0230-30-E0-G0-S1-V04 |
| 30° | E0 | G1 | S0 | 305 | 32 | 50.9 | 52 | 53 | 37 | 305 | 195 | 15 | SN5650-PMO-0230-30-E0-G1-S0-V04 |
| 30° | E0 | G1 | S1 | 305 | 32 | 50.9 | 52 | 53 | 37 | 305 | 195 | 15 | SN5650-PMO-0230-30-E0-G1-S1-V04 |
| 30° | E1 | G0 | S0 | 305 | 32 | 50.9 | 52 | 53 | 37 | 305 | 195 | 15 | SN5650-PMO-0230-30-E1-G0-S0-V04 |
| 30° | E1 | G0 | S1 | 305 | 32 | 50.9 | 52 | 53 | 37 | 305 | 195 | 15 | SN5650-PMO-0230-30-E1-G0-S1-V04 |
| 30° | E1 | G1 | S0 | 305 | 32 | 50.9 | 52 | 53 | 37 | 305 | 195 | 15 | SN5650-PMO-0230-30-E1-G1-S0-V04 |
| 30° | E1 | G1 | S1 | 305 | 32 | 50.9 | 52 | 53 | 37 | 305 | 195 | 15 | SN5650-PMO-0230-30-E1-G1-S1-V04 |
| 35° | E0 | G0 | S0 | 305 | 30 | 49.7 | 47 | 52 | 37 | 305 | 195 | 15 | SN5650-PMO-0230-35-E0-G0-S0-V04 |
| 35° | E0 | G0 | S1 | 305 | 30 | 49.7 | 47 | 52 | 37 | 305 | 195 | 15 | SN5650-PMO-0230-35-E0-G0-S1-V04 |
| 35° | E0 | G1 | S0 | 305 | 30 | 49.7 | 47 | 52 | 37 | 305 | 195 | 15 | SN5650-PMO-0230-35-E0-G1-S0-V04 |
| 35° | E0 | G1 | S1 | 305 | 30 | 49.7 | 47 | 52 | 37 | 305 | 195 | 15 | SN5650-PMO-0230-35-E0-G1-S1-V04 |
| 35° | E1 | G0 | S0 | 305 | 30 | 49.7 | 47 | 52 | 37 | 305 | 195 | 15 | SN5650-PMO-0230-35-E1-G0-S0-V04 |
| 35° | E1 | G0 | S1 | 305 | 30 | 49.7 | 47 | 52 | 37 | 305 | 195 | 15 | SN5650-PMO-0230-35-E1-G0-S1-V04 |
| 35° | E1 | G1 | S0 | 305 | 30 | 49.7 | 47 | 52 | 37 | 305 | 195 | 15 | SN5650-PMO-0230-35-E1-G1-S0-V04 |
| 35° | E1 | G1 | S1 | 305 | 30 | 49.7 | 47 | 52 | 37 | 305 | 195 | 15 | SN5650-PMO-0230-35-E1-G1-S1-V04 |
| 40° | E0 | G0 | S0 | 305 | 27 | 54.7 | 47 | 56.5 | 37 | 305 | 185 | 0 | SN5650-PMO-0230-40-E0-G0-S0-V04 |
| 40° | E0 | G0 | S1 | 305 | 27 | 54.7 | 47 | 56.5 | 37 | 305 | 185 | 0 | SN5650-PMO-0230-40-E0-G0-S1-V04 |
| 40° | E0 | G1 | S0 | 305 | 27 | 54.7 | 47 | 56.5 | 37 | 305 | 185 | 0 | SN5650-PMO-0230-40-E0-G1-S0-V04 |
| 40° | E0 | G1 | S1 | 305 | 27 | 54.7 | 47 | 56.5 | 37 | 305 | 185 | 0 | SN5650-PMO-0230-40-E0-G1-S1-V04 |
| 40° | E1 | G0 | S0 | 305 | 27 | 54.7 | 47 | 56.5 | 37 | 305 | 185 | 0 | SN5650-PMO-0230-40-E1-G0-S0-V04 |
| 40° | E1 | G0 | S1 | 305 | 27 | 54.7 | 47 | 56.5 | 37 | 305 | 185 | 0 | SN5650-PMO-0230-40-E1-G0-S1-V04 |
| 40° | E1 | G1 | S0 | 305 | 27 | 54.7 | 47 | 56.5 | 37 | 305 | 185 | 0 | SN5650-PMO-0230-40-E1-G1-S0-V04 |
| 40° | E1 | G1 | S1 | 305 | 27 | 54.7 | 47 | 56.5 | 37 | 305 | 185 | 0 | SN5650-PMO-0230-40-E1-G1-S1-V04 |
| 45° | E0 | G0 | S0 | 305 | 25 | 60.2 | 47 | 62.5 | 42 | 305 | 185 | 0 | SN5650-PMO-0230-45-E0-G0-S0-V04 |
| 45° | E0 | G0 | S1 | 305 | 25 | 60.2 | 47 | 62.5 | 42 | 305 | 185 | 0 | SN5650-PMO-0230-45-E0-G0-S1-V04 |
| 45° | E0 | G1 | S0 | 305 | 25 | 60.2 | 47 | 62.5 | 42 | 305 | 185 | 0 | SN5650-PMO-0230-45-E0-G1-S0-V04 |
| 45° | E0 | G1 | S1 | 305 | 25 | 60.2 | 47 | 62.5 | 42 | 305 | 185 | 0 | SN5650-PMO-0230-45-E0-G1-S1-V04 |
| 45° | E1 | G0 | S0 | 305 | 25 | 60.2 | 47 | 62.5 | 42 | 305 | 185 | 0 | SN5650-PMO-0230-45-E1-G0-S0-V04 |
| 45° | E1 | G0 | S1 | 305 | 25 | 60.2 | 47 | 62.5 | 42 | 305 | 185 | 0 | SN5650-PMO-0230-45-E1-G0-S1-V04 |
| 45° | E1 | G1 | S0 | 305 | 25 | 60.2 | 47 | 62.5 | 42 | 305 | 185 | 0 | SN5650-PMO-0230-45-E1-G1-S0-V04 |
| 45° | E1 | G1 | S1 | 305 | 25 | 60.2 | 47 | 62.5 | 42 | 305 | 185 | 0 | SN5650-PMO-0230-45-E1-G1-S1-V04 |
| 50° | E0 | G0 | S0 | 320 | 22 | 67.8 | 47 | 69.5 | 47 | 310 | 175 | 10 | SN5650-PMO-0230-50-E0-G0-S0-V04 |
| 50° | E0 | G0 | S1 | 320 | 22 | 67.8 | 47 | 69.5 | 47 | 310 | 175 | 10 | SN5650-PMO-0230-50-E0-G0-S1-V04 |
| 50° | E0 | G1 | S0 | 320 | 22 | 67.8 | 47 | 69.5 | 47 | 310 | 175 | 10 | SN5650-PMO-0230-50-E0-G1-S0-V04 |
| 50° | E0 | G1 | S1 | 320 | 22 | 67.8 | 47 | 69.5 | 47 | 310 | 175 | 10 | SN5650-PMO-0230-50-E0-G1-S1-V04 |
| 50° | E1 | G0 | S0 | 320 | 22 | 67.8 | 47 | 69.5 | 47 | 310 | 175 | 10 | SN5650-PMO-0230-50-E1-G0-S0-V04 |
| 50° | E1 | G0 | S1 | 320 | 22 | 67.8 | 47 | 69.5 | 47 | 310 | 175 | 10 | SN5650-PMO-0230-50-E1-G0-S1-V04 |



| W | E | G | SE | L | W1 | s | S1 | S2 | Sz | L1 | L2 | L3 | No. |
|-----|----|----|----|-----|----|------|----|------|----|-----|-----|----|---------------------------------|
| 50° | E1 | G1 | S0 | 320 | 22 | 67.8 | 47 | 69.5 | 47 | 310 | 175 | 10 | SN5650-PMO-0230-50-E1-G1-S0-V04 |
| 50° | E1 | G1 | S1 | 320 | 22 | 67.8 | 47 | 69.5 | 47 | 310 | 175 | 10 | SN5650-PMO-0230-50-E1-G1-S1-V04 |
| 55° | E0 | G0 | S0 | 320 | 20 | 68.8 | 42 | 70.7 | 47 | 310 | 175 | 10 | SN5650-PMO-0230-55-E0-G0-S0-V04 |
| 55° | E0 | G0 | S1 | 320 | 20 | 68.8 | 42 | 70.7 | 47 | 310 | 175 | 10 | SN5650-PMO-0230-55-E0-G0-S1-V04 |
| 55° | E0 | G1 | S0 | 320 | 20 | 68.8 | 42 | 70.7 | 47 | 310 | 175 | 10 | SN5650-PMO-0230-55-E0-G1-S0-V04 |
| 55° | E0 | G1 | S1 | 320 | 20 | 68.8 | 42 | 70.7 | 47 | 310 | 175 | 10 | SN5650-PMO-0230-55-E0-G1-S1-V04 |
| 55° | E1 | G0 | S0 | 320 | 20 | 68.8 | 42 | 70.7 | 47 | 310 | 175 | 10 | SN5650-PMO-0230-55-E1-G0-S0-V04 |
| 55° | E1 | G0 | S1 | 320 | 20 | 68.8 | 42 | 70.7 | 47 | 310 | 175 | 10 | SN5650-PMO-0230-55-E1-G0-S1-V04 |
| 55° | E1 | G1 | S0 | 320 | 20 | 68.8 | 42 | 70.7 | 47 | 310 | 175 | 10 | SN5650-PMO-0230-55-E1-G1-S0-V04 |
| 55° | E1 | G1 | S1 | 320 | 20 | 68.8 | 42 | 70.7 | 47 | 310 | 175 | 10 | SN5650-PMO-0230-55-E1-G1-S1-V04 |
| 60° | E0 | G0 | S0 | 325 | 17 | 70.8 | 37 | 72.1 | 27 | 315 | 160 | 10 | SN5650-PMO-0230-60-E0-G0-S0-V04 |
| 60° | E0 | G0 | S1 | 325 | 17 | 70.8 | 37 | 72.1 | 27 | 315 | 160 | 10 | SN5650-PMO-0230-60-E0-G0-S1-V04 |
| 60° | E0 | G1 | S0 | 325 | 17 | 70.8 | 37 | 72.1 | 27 | 315 | 160 | 10 | SN5650-PMO-0230-60-E0-G1-S0-V04 |
| 60° | E0 | G1 | S1 | 325 | 17 | 70.8 | 37 | 72.1 | 27 | 315 | 160 | 10 | SN5650-PMO-0230-60-E0-G1-S1-V04 |
| 60° | E1 | G0 | S0 | 325 | 17 | 70.8 | 37 | 72.1 | 27 | 315 | 160 | 10 | SN5650-PMO-0230-60-E1-G0-S0-V04 |
| 60° | E1 | G0 | S1 | 325 | 17 | 70.8 | 37 | 72.1 | 27 | 315 | 160 | 10 | SN5650-PMO-0230-60-E1-G0-S1-V04 |
| 60° | E1 | G1 | S0 | 325 | 17 | 70.8 | 37 | 72.1 | 27 | 315 | 160 | 10 | SN5650-PMO-0230-60-E1-G1-S0-V04 |
| 60° | E1 | G1 | S1 | 325 | 17 | 70.8 | 37 | 72.1 | 27 | 315 | 160 | 10 | SN5650-PMO-0230-60-E1-G1-S1-V04 |
| 65° | E0 | G0 | S0 | 325 | 15 | 73.1 | 32 | 74.6 | 27 | 315 | 160 | 10 | SN5650-PMO-0230-65-E0-G0-S0-V04 |
| 65° | E0 | G0 | S1 | 325 | 15 | 73.1 | 32 | 74.6 | 27 | 315 | 160 | 10 | SN5650-PMO-0230-65-E0-G0-S1-V04 |
| 65° | E0 | G1 | S0 | 325 | 15 | 73.1 | 32 | 74.6 | 27 | 315 | 160 | 10 | SN5650-PMO-0230-65-E0-G1-S0-V04 |
| 65° | E0 | G1 | S1 | 325 | 15 | 73.1 | 32 | 74.6 | 27 | 315 | 160 | 10 | SN5650-PMO-0230-65-E0-G1-S1-V04 |
| 65° | E1 | G0 | S0 | 325 | 15 | 73.1 | 32 | 74.6 | 27 | 315 | 160 | 10 | SN5650-PMO-0230-65-E1-G0-S0-V04 |
| 65° | E1 | G0 | S1 | 325 | 15 | 73.1 | 32 | 74.6 | 27 | 315 | 160 | 10 | SN5650-PMO-0230-65-E1-G0-S1-V04 |
| 65° | E1 | G1 | S0 | 325 | 15 | 73.1 | 32 | 74.6 | 27 | 315 | 160 | 10 | SN5650-PMO-0230-65-E1-G1-S0-V04 |
| 65° | E1 | G1 | S1 | 325 | 15 | 73.1 | 32 | 74.6 | 27 | 315 | 160 | 10 | SN5650-PMO-0230-65-E1-G1-S1-V04 |
| 70° | E0 | G0 | S0 | 340 | 12 | 77.2 | 27 | 78.2 | 47 | 330 | 145 | 10 | SN5650-PMO-0230-70-E0-G0-S0-V04 |
| 70° | E0 | G0 | S1 | 340 | 12 | 77.2 | 27 | 78.2 | 47 | 330 | 145 | 10 | SN5650-PMO-0230-70-E0-G0-S1-V04 |
| 70° | E0 | G1 | S0 | 340 | 12 | 77.2 | 27 | 78.2 | 47 | 330 | 145 | 10 | SN5650-PMO-0230-70-E0-G1-S0-V04 |
| 70° | E0 | G1 | S1 | 340 | 12 | 77.2 | 27 | 78.2 | 47 | 330 | 145 | 10 | SN5650-PMO-0230-70-E0-G1-S1-V04 |
| 70° | E1 | G0 | S0 | 340 | 12 | 77.2 | 27 | 78.2 | 47 | 330 | 145 | 10 | SN5650-PMO-0230-70-E1-G0-S0-V04 |
| 70° | E1 | G0 | S1 | 340 | 12 | 77.2 | 27 | 78.2 | 47 | 330 | 145 | 10 | SN5650-PMO-0230-70-E1-G0-S1-V04 |
| 70° | E1 | G1 | S0 | 340 | 12 | 77.2 | 27 | 78.2 | 47 | 330 | 145 | 10 | SN5650-PMO-0230-70-E1-G1-S0-V04 |
| 70° | E1 | G1 | S1 | 340 | 12 | 77.2 | 27 | 78.2 | 47 | 330 | 145 | 10 | SN5650-PMO-0230-70-E1-G1-S1-V04 |
| 75° | E0 | G0 | S0 | 340 | 10 | 83.7 | 22 | 84.7 | 47 | 330 | 145 | 10 | SN5650-PMO-0230-75-E0-G0-S0-V04 |
| 75° | E0 | G0 | S1 | 340 | 10 | 83.7 | 22 | 84.7 | 47 | 330 | 145 | 10 | SN5650-PMO-0230-75-E0-G0-S1-V04 |
| 75° | E0 | G1 | S0 | 340 | 10 | 83.7 | 22 | 84.7 | 47 | 330 | 145 | 10 | SN5650-PMO-0230-75-E0-G1-S0-V04 |
| 75° | E0 | G1 | S1 | 340 | 10 | 83.7 | 22 | 84.7 | 47 | 330 | 145 | 10 | SN5650-PMO-0230-75-E0-G1-S1-V04 |
| 75° | E1 | G0 | S0 | 340 | 10 | 83.7 | 22 | 84.7 | 47 | 330 | 145 | 10 | SN5650-PMO-0230-75-E1-G0-S0-V04 |
| 75° | E1 | G0 | S1 | 340 | 10 | 83.7 | 22 | 84.7 | 47 | 330 | 145 | 10 | SN5650-PMO-0230-75-E1-G0-S1-V04 |
| 75° | E1 | G1 | S0 | 340 | 10 | 83.7 | 22 | 84.7 | 47 | 330 | 145 | 10 | SN5650-PMO-0230-75-E1-G1-S0-V04 |
| 75° | E1 | G1 | S1 | 340 | 10 | 83.7 | 22 | 84.7 | 47 | 330 | 145 | 10 | SN5650-PMO-0230-75-E1-G1-S1-V04 |

SN5650-PMO-0230-

Bauteile Components

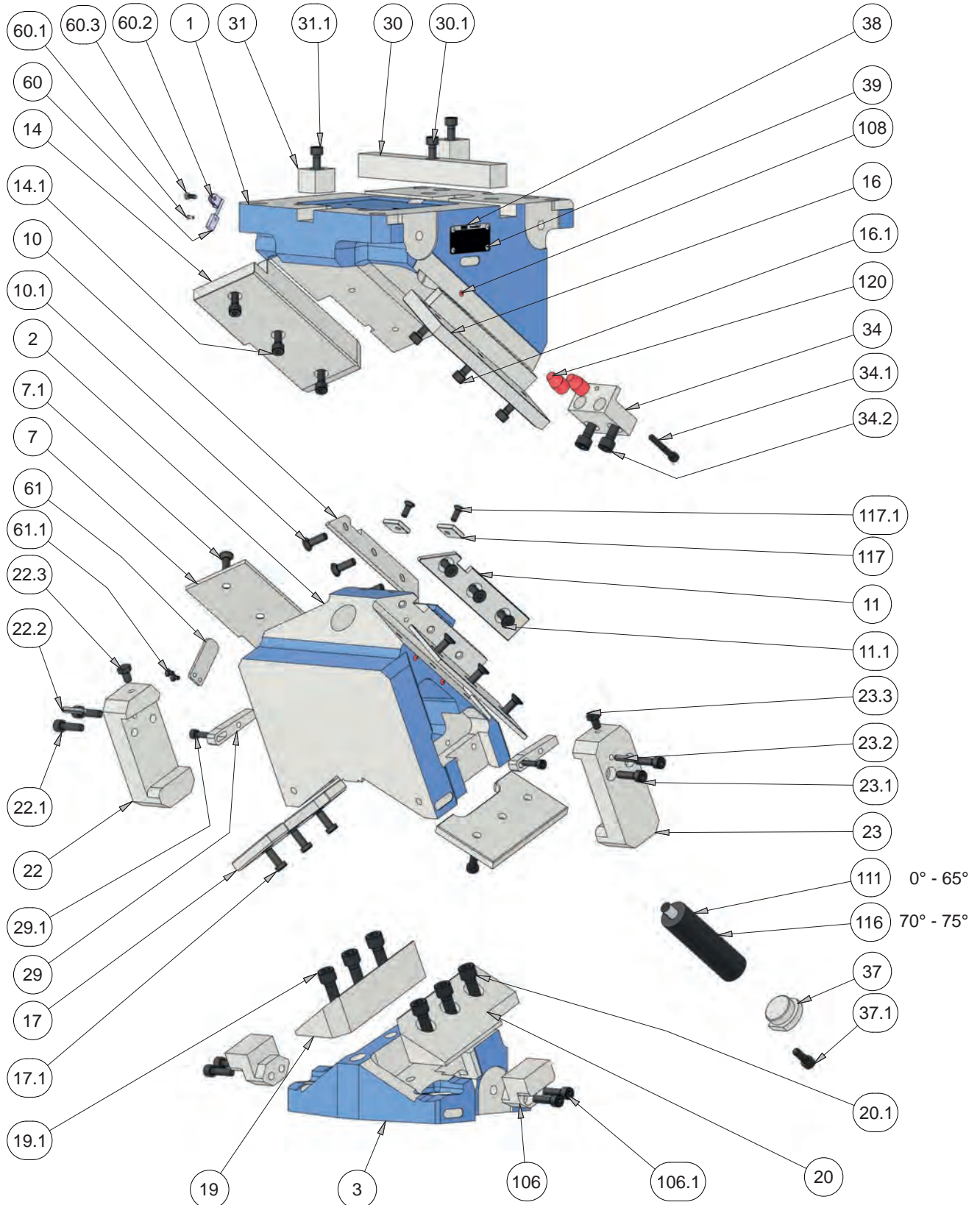

SN5650-PMO-0230-

Kraftverteilung

Force Distribution

| W | FS [kN] | FP [kN] | Fh1 [kN] | FW [kN] | Fh2 [kN] | h1 [mm] | h2 [mm] | FA [kN] |
|-----|---------|---------|----------|---------|----------|---------|---------|---------|
| 00° | 490 | 460 | 490 | 460 | 0 | 152 | 40 | 46 |
| 05° | 525 | 495 | 482 | 446 | 38 | 145 | 50 | 45 |
| 10° | 559 | 530 | 474 | 433 | 76 | 137 | 60 | 44 |
| 15° | 577 | 549 | 450 | 399 | 105 | 130 | 68 | 43 |
| 20° | 595 | 569 | 426 | 365 | 133 | 122 | 75 | 42 |
| 25° | 610 | 585 | 400 | 327 | 150 | 122 | 75 | 44 |
| 30° | 624 | 601 | 374 | 289 | 167 | 122 | 75 | 45 |
| 35° | 660 | 637 | 358 | 258 | 179 | 115 | 73 | 48 |
| 40° | 695 | 674 | 342 | 227 | 191 | 107 | 71 | 50 |
| 45° | 707 | 688 | 312 | 189 | 185 | 97 | 83 | 51 |
| 50° | 718 | 701 | 282 | 151 | 180 | 87 | 95 | 54 |
| 55° | 714 | 699 | 247 | 117 | 162 | 85 | 109 | 51 |
| 60° | 710 | 697 | 212 | 83 | 143 | 82 | 122 | 53 |
| 65° | 718 | 705 | 188 | 54 | 116 | 80 | 120 | 52 |
| 70° | 735 | 722 | 206 | 84 | 122 | 76 | 115 | 53 |
| 75° | 752 | 744 | 130 | 17 | 65 | 65 | 135 | 52 |

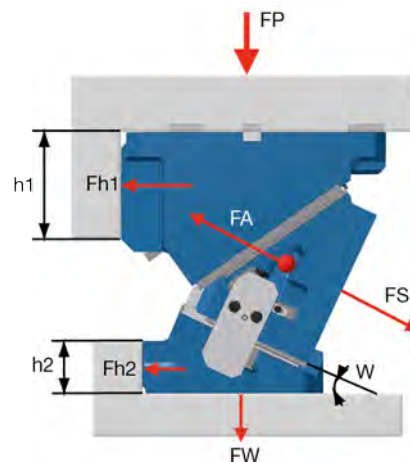

W = Schieberwinkel
FP = P-Presse
FW = W-Werkzeug
FS = S-Schieberkraft
FA = A-Abstreifkraft
Fh1 = h1-Abschulterung oben
Fh2 = h2-Abschulterung unten

W = Cam Angle
FP = P-Press
FW = W-Tool
FS = S-Cam Force
FA = A-Retractility
Fh1 = h1-Shouldering above
Fh2 = h2-Shouldering below

SN5650-PMO-0230-

Schieberkräfte

Cam Force

Abschulterung

Shouldering

Passfeder

Fitting Key

SN5650-PMO-0230-0°

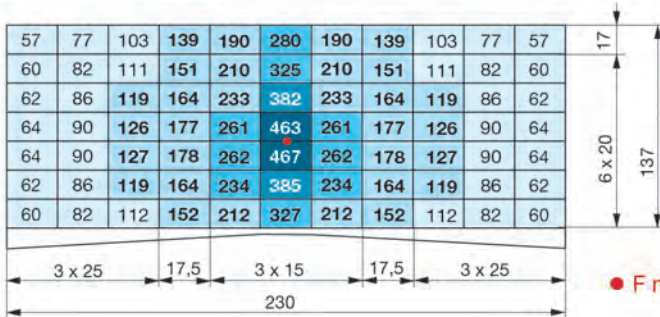

● F max. = 490 kN

| | | | | | | | | | | |
|----|----|----|----|----|-----|----|----|----|----|----|
| 50 | 61 | 73 | 83 | 92 | 104 | 92 | 83 | 73 | 61 | 50 |
| 50 | 61 | 73 | 83 | 92 | 104 | 92 | 83 | 73 | 61 | 50 |
| 50 | 61 | 73 | 83 | 92 | 104 | 92 | 83 | 73 | 61 | 50 |
| 50 | 61 | 73 | 83 | 92 | 104 | 92 | 83 | 73 | 61 | 50 |
| 50 | 61 | 73 | 83 | 92 | 104 | 92 | 83 | 73 | 61 | 50 |
| 50 | 61 | 73 | 83 | 92 | 104 | 92 | 83 | 73 | 61 | 50 |
| 50 | 61 | 73 | 83 | 92 | 104 | 92 | 83 | 73 | 61 | 50 |

SN5650-PMO-0230-10°

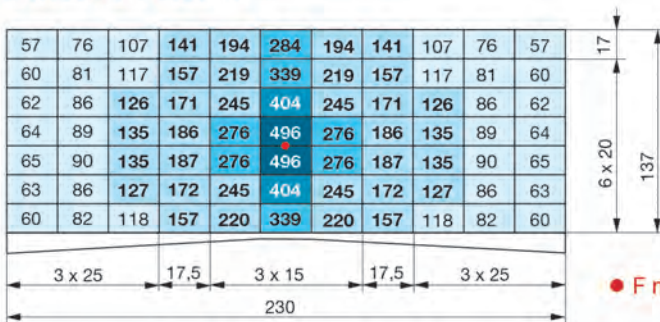

● F max. = 559 kN

| | | | | | | | | | | |
|----|----|----|----|-----|-----|-----|----|----|----|----|
| 53 | 65 | 83 | 95 | 108 | 122 | 108 | 95 | 83 | 65 | 53 |
| 53 | 65 | 82 | 95 | 108 | 122 | 108 | 95 | 82 | 65 | 53 |
| 53 | 65 | 82 | 95 | 108 | 122 | 108 | 95 | 82 | 65 | 53 |
| 53 | 65 | 82 | 95 | 108 | 122 | 108 | 95 | 82 | 65 | 53 |
| 53 | 65 | 82 | 95 | 108 | 122 | 108 | 95 | 82 | 65 | 53 |
| 53 | 65 | 82 | 95 | 108 | 122 | 108 | 95 | 82 | 65 | 53 |
| 53 | 65 | 82 | 95 | 108 | 122 | 108 | 95 | 82 | 65 | 53 |

SN5650-PMO-0230-20°

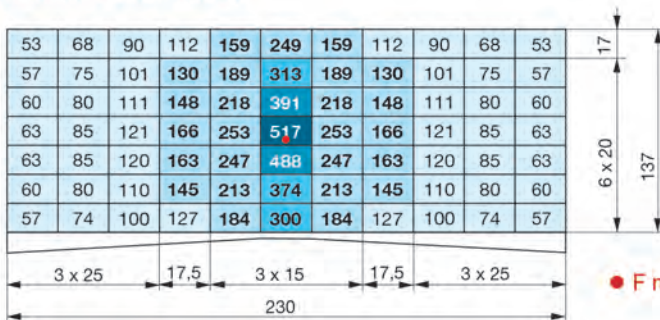

● F max. = 595 kN

| | | | | | | | | | | |
|----|----|----|-----|-----|-----|-----|-----|----|----|----|
| 53 | 67 | 86 | 103 | 122 | 146 | 122 | 103 | 86 | 67 | 53 |
| 55 | 67 | 85 | 102 | 121 | 146 | 121 | 102 | 85 | 67 | 55 |
| 55 | 67 | 85 | 102 | 121 | 146 | 121 | 102 | 85 | 67 | 55 |
| 55 | 67 | 85 | 102 | 121 | 146 | 121 | 102 | 85 | 67 | 55 |
| 55 | 67 | 85 | 102 | 121 | 146 | 121 | 102 | 85 | 67 | 55 |
| 55 | 67 | 85 | 102 | 121 | 146 | 121 | 102 | 85 | 67 | 55 |
| 55 | 67 | 85 | 102 | 121 | 146 | 121 | 102 | 85 | 67 | 55 |

SN5650-PMO-0230-30°

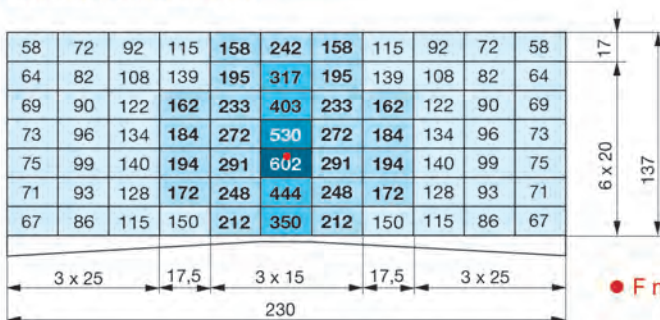

● F max. = 624 kN

| | | | | | | | | | | |
|----|----|----|-----|-----|-----|-----|-----|----|----|----|
| 58 | 72 | 92 | 115 | 143 | 175 | 143 | 115 | 92 | 72 | 58 |
| 61 | 75 | 96 | 119 | 142 | 175 | 142 | 119 | 96 | 75 | 61 |
| 61 | 75 | 96 | 118 | 142 | 175 | 142 | 118 | 96 | 75 | 61 |
| 61 | 75 | 96 | 118 | 142 | 175 | 142 | 118 | 96 | 75 | 61 |
| 61 | 75 | 96 | 118 | 142 | 175 | 142 | 118 | 96 | 75 | 61 |
| 61 | 75 | 96 | 118 | 142 | 175 | 142 | 118 | 96 | 75 | 61 |
| 61 | 75 | 96 | 118 | 142 | 175 | 142 | 118 | 96 | 75 | 61 |

SN5650-PMO-0230-

Schieberkräfte

Cam Force

Abschulterung

Shouldering

Passfeder

Fitting Key

SN5650-PMO-0230-40°

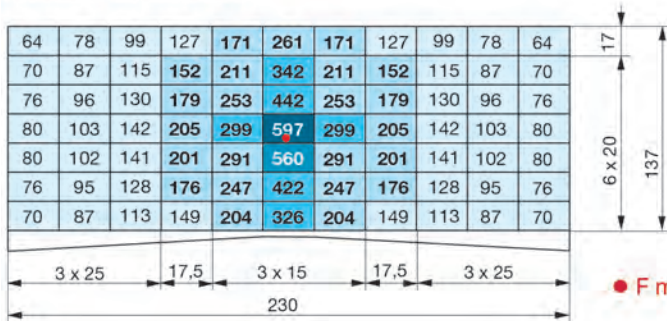

● F max. = 695 kN

| | | | | | | | | | | |
|----|----|-----|-----|-----|-----|-----|-----|-----|----|----|
| 64 | 78 | 99 | 127 | 171 | 213 | 171 | 127 | 99 | 78 | 64 |
| 70 | 85 | 110 | 142 | 172 | 213 | 172 | 142 | 110 | 85 | 70 |
| 70 | 85 | 110 | 141 | 171 | 213 | 171 | 141 | 110 | 85 | 70 |
| 70 | 85 | 110 | 141 | 171 | 213 | 171 | 141 | 110 | 85 | 70 |
| 70 | 85 | 110 | 141 | 171 | 213 | 171 | 141 | 110 | 85 | 70 |
| 70 | 85 | 110 | 141 | 171 | 213 | 171 | 141 | 110 | 85 | 70 |
| 70 | 85 | 110 | 142 | 172 | 213 | 172 | 142 | 110 | 85 | 70 |

SN5650-PMO-0230-50°

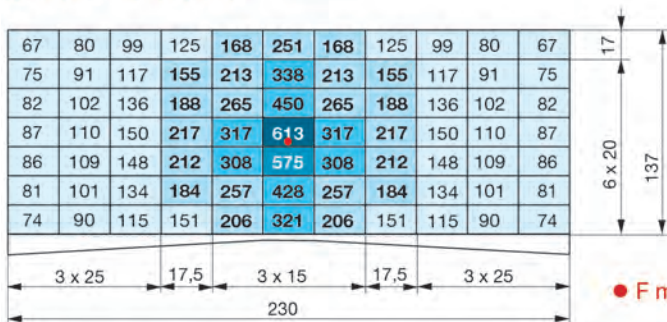

● F max. = 718 kN

| | | | | | | | | | | |
|----|-----|-----|-----|-----|-----|-----|-----|-----|-----|----|
| 67 | 80 | 99 | 125 | 168 | 251 | 168 | 125 | 99 | 80 | 67 |
| 75 | 91 | 117 | 155 | 213 | 268 | 213 | 155 | 117 | 91 | 75 |
| 82 | 102 | 131 | 173 | 214 | 268 | 214 | 173 | 131 | 102 | 82 |
| 83 | 102 | 131 | 173 | 214 | 268 | 214 | 173 | 131 | 102 | 83 |
| 83 | 102 | 131 | 173 | 214 | 268 | 214 | 173 | 131 | 102 | 83 |
| 81 | 101 | 131 | 173 | 214 | 268 | 214 | 173 | 131 | 101 | 81 |
| 74 | 90 | 115 | 151 | 206 | 268 | 206 | 151 | 115 | 90 | 74 |

SN5650-PMO-0230-60°

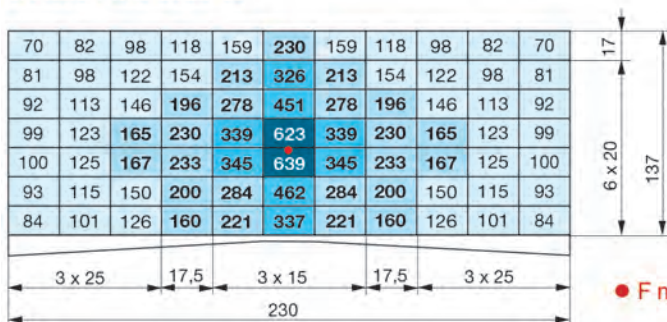

● F max. = 710 kN

| | | | | | | | | | | |
|-----|-----|-----|-----|-----|-----|-----|-----|-----|-----|-----|
| 70 | 82 | 98 | 118 | 159 | 230 | 159 | 118 | 98 | 82 | 70 |
| 81 | 98 | 122 | 154 | 213 | 326 | 213 | 154 | 122 | 98 | 81 |
| 92 | 113 | 146 | 196 | 278 | 352 | 278 | 196 | 146 | 113 | 92 |
| 99 | 123 | 165 | 218 | 280 | 352 | 280 | 218 | 165 | 123 | 99 |
| 100 | 125 | 166 | 218 | 280 | 352 | 280 | 218 | 166 | 125 | 100 |
| 93 | 115 | 150 | 200 | 280 | 352 | 280 | 200 | 150 | 115 | 93 |
| 84 | 101 | 126 | 160 | 221 | 337 | 221 | 160 | 126 | 101 | 84 |

SN5650-PMO-0230-70°

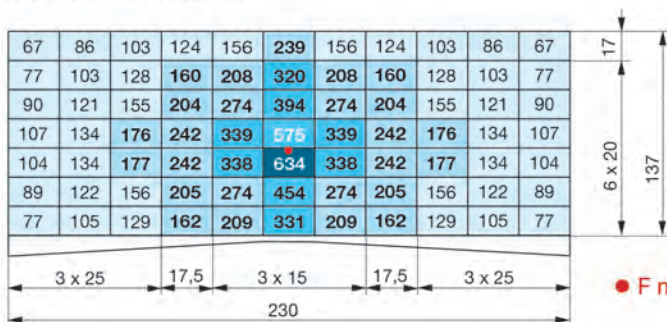

● F max. = 735 kN

| | | | | | | | | | | |
|-----|-----|-----|-----|-----|-----|-----|-----|-----|-----|-----|
| 69 | 86 | 103 | 124 | 156 | 239 | 156 | 124 | 103 | 86 | 69 |
| 79 | 103 | 128 | 160 | 208 | 285 | 208 | 160 | 128 | 103 | 79 |
| 94 | 121 | 152 | 196 | 249 | 303 | 249 | 196 | 152 | 121 | 94 |
| 106 | 130 | 167 | 220 | 288 | 403 | 288 | 220 | 167 | 130 | 106 |
| 98 | 131 | 168 | 222 | 291 | 438 | 291 | 222 | 168 | 131 | 98 |
| 86 | 122 | 154 | 199 | 252 | 374 | 252 | 199 | 154 | 122 | 86 |
| 75 | 105 | 129 | 162 | 209 | 305 | 209 | 162 | 129 | 105 | 75 |