

3

## Abstimmsscheiben

## Raising washers

## Rondelles d'ajustement

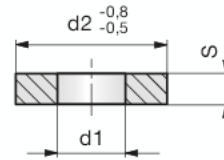
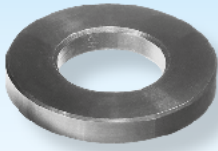

**SN2512-**

Mat.: ST/58 ±2HRC

SN2512-d2



**d2**

**d1**

**S**

20

10,5

4

25

13,0

4

32

16,5

4

40

20,5

5

50

25,5

5

## Spannscheiben

## Strain washers

## Rondelles de fixation

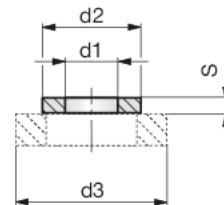
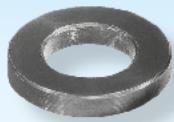

**SN2513-**

Mat.: ST/58 ±2HRC

SN2513-d3



**d3**

**d2**

**d1**

**S**

20

13

6,5

3

25

16

8,5

3

32

19

10,5

3

40

22

12,5

4

50

28

16,5

4