

3

## Federteller für Elastomerfedern

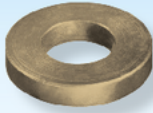

**SN2649-**

Mat.: MS58  
DIN 9835, A



SN2649-d3

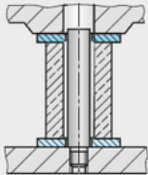

## Spring plates for elastomer springs

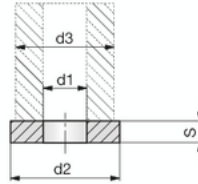

d3	d1	d2	s	⊗
16	6,5	20	4	10
20	8,5	25	4	10
25	10,5	30	5	10
32	13,5	40	5	10
40	13,5	50	5	5
50	16,5	60	6	5
63	16,5	80	6	5
80	20,5	100	8	2
100	20,5	120	8	2
125	26,0	150	8	2

## Godets ou disque pour ressorts élastomère

## Zentriersäulen für Elastomerfedern



**SN2650-**

Mat.: ST  
DIN 9835, B



SN2650-d1-L

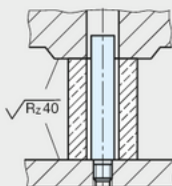

## Guide bolts for elastomer springs

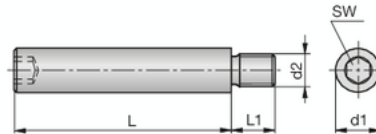

d1	L	L1	d2	SW	⊗	d1	L	L1	d2	SW	⊗
6	20	6	M4	3	10	13	80	15	M10	6	6
	25	6	M4	3	10		95	15	M10	6	6
	32	6	M4	3	10		16	40	18	M12	8
8	25	9	M6	4	10	50	18	M12	8	6	
	32	9	M6	4	10	63	18	M12	8	6	
	40	9	M6	4	10	80	18	M12	8	6	
	50	9	M6	4	10	95	18	M12	8	2	
10	25	15	M8	5	10	118	18	M12	8	2	
	40	15	M8	5	10	20	50	25	M16	10	2
	50	15	M8	5	6	63	25	M16	10	2	
13	63	15	M8	5	6	80	25	M16	10	2	
	40	15	M10	6	6	95	25	M16	10	2	
	50	15	M10	6	6	118	25	M16	10	2	
	63	15	M10	6	6	140	25	M16	10	2	

## Axes de guidage pour ressorts élastomère