

## Zentriereinheiten

## Centring elements

## Unités de centrage

DLC 



Flache Ausführung  
Flat design  
Exécution plate

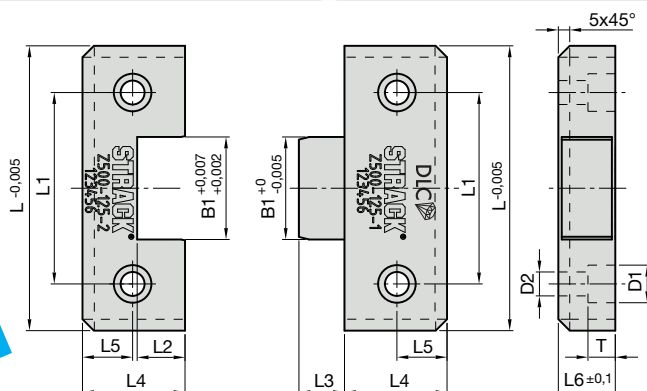

**Z500-**

Mat.: ST  
~ 52HRC  
DLC

L	L1	L2	L3	L4	L5	L6	B1	D1	D2	T	R
125	84	21	20	45	22	25	45	16,5	10,5	12	3



Z500-L

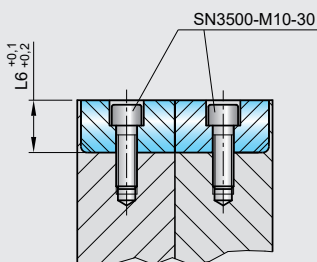

**SN3500\***

\* nicht im Lieferumfang enthalten  
not included in the extent of delivery  
non compris dans le volume de livraison

### Mögliche Einbauvariante

### Possible installation variant

### Des variantes d'installation possible

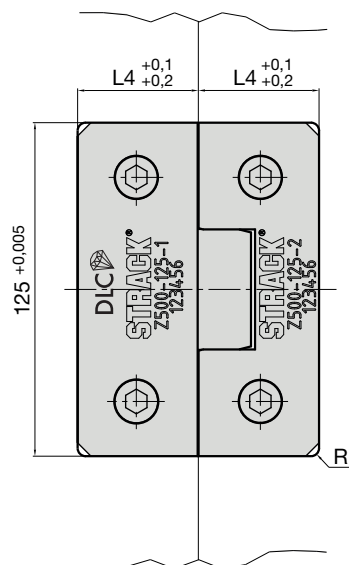
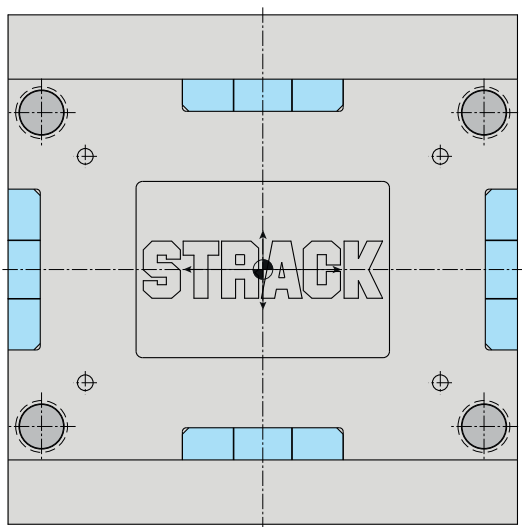

## Zentriereinheiten

## Centring elements

## Unités de centrage

DLC 



Flache Ausführung  
Flat design  
Exécution plate

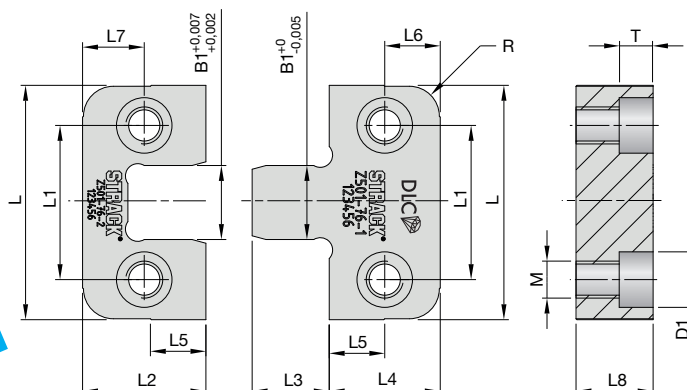

Z501-

Mat.: ST  
~ 52HRC  
DLC



Z501-L



L	B1	L1	L2	L3	L4	L5	L6	L7	L8	R	D1	M	T
40	10	26	17	11	14	6	7	8,5	10	4	10	M6	5,7
46	12	30	22	12	17	7	8,5	11	12	5	11	M8	6,8
50	14	34	27	16	22	10	11	13,5	16	6	11	M8	6,8
60	18	40	36	20	27	14	13,5	18	20	8	15	M10	9
76	24	50	40	25	36	18	18	20	25	10	18	M12	11

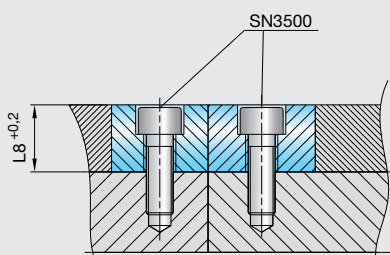

L	SN3500*
40	M5x12
46	M6x16
50	M6x20
60	M8x25
76	M10x30

\* nicht im Lieferumfang enthalten  
not included in the extent of delivery  
non compris dans le volume de livraison

### Mögliche Einbauvariante

### Possible installation variant

### Des variantes d'installation possible

